

LAFFERTY EQUIPMENT MFG., INC.

INSTALLATION / OPERATION INSTRUCTIONS

HIGH PRESSURE CHEMICAL / RINSE HOSE DROP STATION

Requirements

400 – 1000 PSI Water — Up to 10 GPM
3/8" I.D. Discharge Hose

Water Temperature
Ambient to 160° F



OPTIONS

- *Stainless Steel "Y" Strainer*
- *Stainless Steel Hose Rack*
- *1 Gallon Stainless Steel Jug Rack (round OR square)*
- *2 ½ Gallon Stainless Steel Jug Rack (inside dimensions 8 ½" x 10 ½")*
- *5 Gallon Stainless Steel Jug Rack (inside dimensions 12" x 12")*

Model #918325 -W10SS

Model #918327 -W20SS
(with nozzle only)

Model #918333 -W10SS Complete

Model #918335 -W20SS Complete

(with 50' hose, trigger gun, wand, and nozzle)

**For Lower Pressures or Higher Volume GPM,
ask about our LC and LPSS Hose Drop Stations**

INSTALLATION AND OPERATION INSTRUCTIONS

HIGH PRESSURE CHEMICAL / RINSE HOSE DROP STATION

CAUTION: Always observe good safety habits. Wear protective clothing, gloves, and eye wear. Direct discharge away from yourself and others.

TO INSTALL (See Parts Diagram, Facing Page)

1. Mount the High Pressure Chemical/Rinse Hose Drop Station to a suitable surface.
2. Connect your water line to the station (see diagram). Loosen strainer cap from strainer body to create a swivel union effect for easy installation and cleaning or replacement of **water strainer element**.
3. Connect the trigger gun assembly, and QD socket to the hose as shown in diagram. [**Hose must be 3/8" I.D. Use only the nozzle supplied with station.**]
4. *Stapled to these instructions, with a matching color-coded chart, are metering tips which control your chemical to water dilutions. You will need to know the water pressure and the number of ounces of chemical needed per gallon of water to determine the correct tip color. (See chemical label for manufacturer's recommendation.)*
 - A. Locate your water pressure in the chart. The number below it is your water flow rate in **gallons per minute**.
 - B. Multiply the **gallons per minute** by the number of **ounces of chemical needed per gallon** of water.
 - C. Match answer(s) to the *nearest* number in metering tip selection chart. [**The tip selection chart is based on water-thin chemical. Thicker chemicals will require a larger metering tip.**]

EXAMPLE OF METERING TIP SELECTION
W20 Injector at 600 PSI

- 600 PSI = 3.7 GPM
- 1 ounce of chemical per 4 gallons of water
- $3.7 \times .25 = .93$ ounces of chemical
- $.93 \cong .84$ for thin chemical (Brown tip)

- D. Open cover. Install selected metering tip into solution check valve. Next, push chemical tube over the check valve and close cover. Immerse the chemical strainer into your chemical concentrate.

TO APPLY CHEMICAL

(NOTE: Do not change the nozzle size, nozzle **MUST** match injector.)

1. With gun in hand, securely quick connect the hose assembly to the chemical QD plug.
2. Open the chemical ball valve. Move to the area of application. Then, depress the trigger on the gun and begin application.
3. When finished, return to the station and close the chemical ball valve. Depress the trigger on the gun.

TO RINSE

1. With gun in hand, securely quick connect the hose to the rinse QD plug. Open the rinse ball valve. Move to the area to be rinsed. Then, depress the trigger on the gun and begin rinsing.
2. When rinsing is completed, return to the station and close the rinse ball valve. Depress trigger to relieve pressure in hose. Store hose — optional hose rack is available.

CAUTION: SHUT DOWN AFTER EACH USE! NEVER LEAVE STATION UNATTENDED WITHOUT CLOSING THE INCOMING VALVES AND RELIEVING PRESSURE IN THE HOSE.

PREVENTIVE MAINTENANCE: When the station will be out of service for extended periods, the risk of residual chemical build-up is increased. To prevent build-up, remove chemical tube from chemical concentrate and place it in warm water. Completely open the water supply valve for 30 seconds to flush. Check and/or clean chemical strainer; replace if missing.

INJECTOR	NOZZLE SIZE	INJECTOR WATER FLOW RATE						
		400 PSI	500 PSI	600 PSI	700 PSI	800 PSI	900 PSI	1000 PSI
W10	2510	1.3 GPM	1.4 GPM	1.5 GPM	1.6 GPM	1.74 GPM	1.89 GPM	1.96 GPM
W20	2520	3.0 GPM	3.4 GPM	3.7 GPM	4.0 GPM	4.2 GPM	4.65 GPM	4.8 GPM

The number under each color in the chart below represents the **average ounces of water-thin chemical which will pass through the tip per minute.**

METERING TIP SELECTION IN OUNCES PER MINUTE (AVERAGE)																				
COLOR	Brown	Clear	Bright Purple	White	Pink	Corn Yellow	Dark Green	Orange	Gray	Light Green	Medium Green	Clear Pink	Yellow Green	Burgundy	Pale Pink	Light Blue	Dark Purple	Navy Blue	Clear Aqua	Black
Thin Chemical	0.84	1.16	1.4	2.0	2.7	3.4	4.0	5.3	6.1	7.0	8.5	9.2	11.2	12.5	12.9	14.2	17.6	21.4	30.2	40.4

HIGH PRESSURE CHEMICAL / RINSE HOSE DROP STATION COMPLETE

QTY.	CALL #	DESCRIPTION	PART #
1	1	STRAINER BODY, SS, 3/8"	552020
1	2	STRAINER ELEMENT	552009
1	3	STRAINER ADAPTER, SS, 1/8"	552005
1	4	STRAINER CAP, SS	552004
1	5	BUSHING, 3/8" x 1/8"	305212
1	6	TEE, ST., 3/8"	692495
2	7	BALL VALVE, SS, 3/8"	413659
1	8	NIPPLE, SS, 3/8" x 6"	429735
2	9	QUICK DISCONNECT, FE PLUG, 3/8"	350443
1	10	QUICK DISCONNECT, FE SOCKET, 3/8"	350446
1	11	NIPPLE, SS, 3/8" x 4"	429725
1	12	ELBOW, ST., 3/8"	257380
2	13	NIPPLE, SS, 3/8" x 1 1/2"	429711
1	14	INJECTOR BODY, W-10, SS, 3/8"	382010
		INJECTOR BODY, W-20, SS, 3/8"	382020
1	15	ELBOW, ST., 1/4"	257378
1	16	CHECK VALVE, SOLUTION, SS, 1/4"	491324
1	17	METERING TIPS, SET (20)	443798
1	18	TUBE, CHEMICAL, 1/4" x 6"	474745
1	19	STRAINER, CHEMICAL, HASTELLOY, 1/4"	150115
6	20	PLATE, # 6 U-BOLT	398495
2	21	U-BOLT ASSEMBLY, #6 SQUARE	392486
1	22	BASE & COVER, S/R	222114
1	23	NOZZLE, SS, 1/4", 2510	MATCHES 180126
		NOZZLE, SS, 1/4", 2520	INJECTOR 180131
1	24	HOSE, HP, 3/8" x 50' BNM	195191
1	25	GUN, JA, TRIGGER	320425
1	26	WAND, SS, 1/4" x 18"	536518
1	27	COUPLING, HEX, 1/4"	506668

Not included with Model #s 918325 and 918327.

Water Supply
400 - 1000 PSI

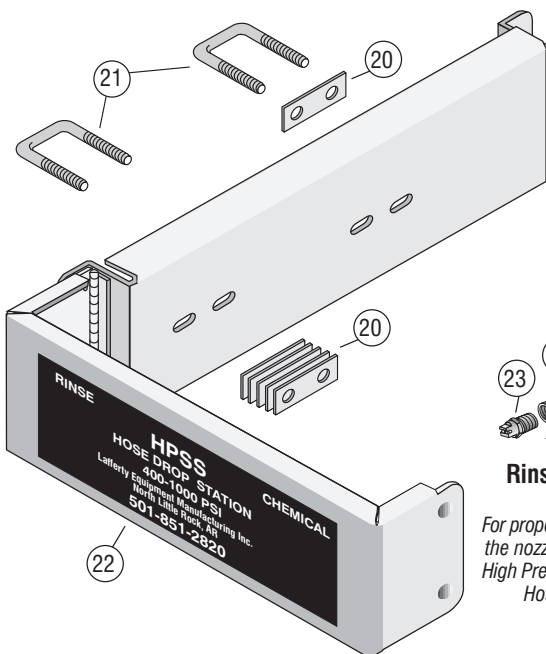
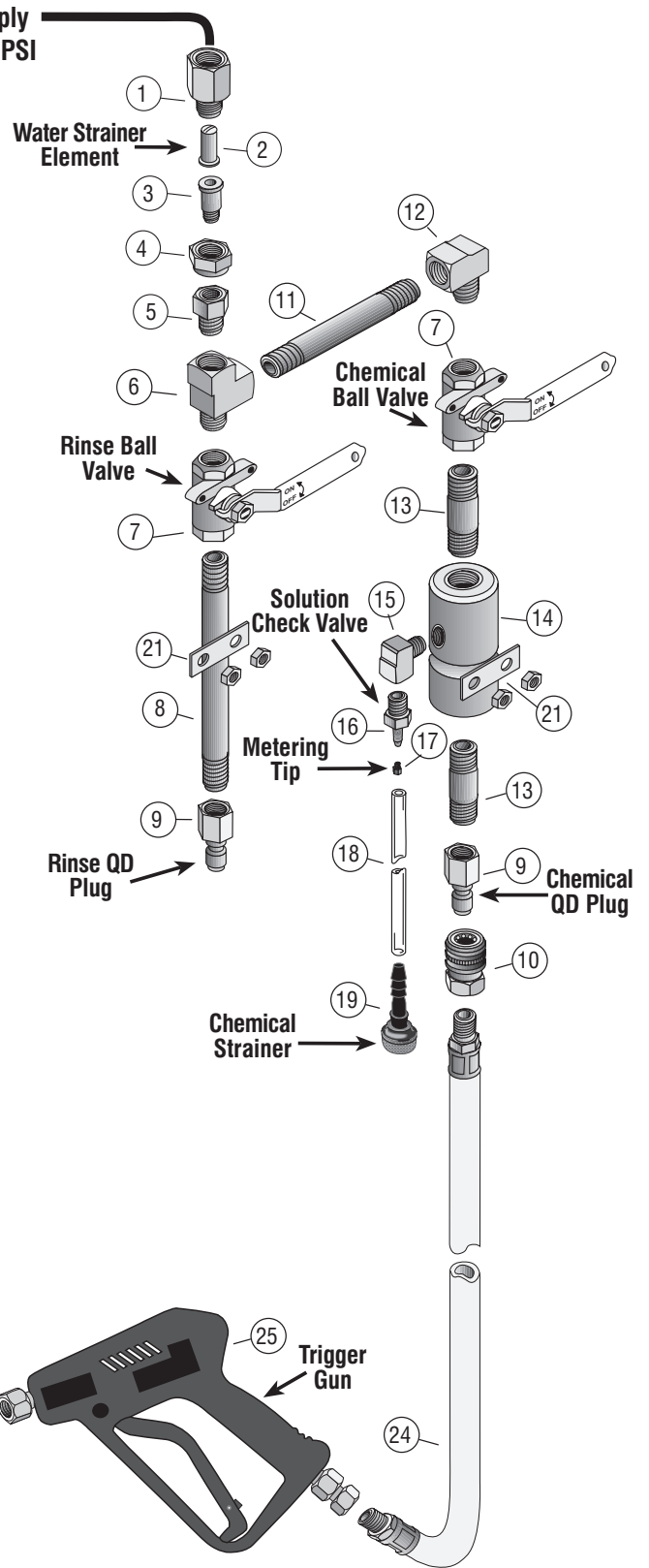

Rinse/Chemical
Nozzle

For proper operation, use ONLY
the nozzle supplied with your
High Pressure Chemical/Rinse
Hose Drop Station.

Drawing not "to scale"

TROUBLE SHOOTING GUIDE *for* HIGH PRESSURE CHEMICAL/ RINSE HOSE DROP STATION

PROBLEMS	POSSIBLE CAUSE / SOLUTION											
	1	2	3	4	5	6	7	8	9	10	11	12
A) Station will not draw chemical.	•	•	•	•	•	•	•	•	•			•
B) Water flowing into chemical container.				•								
C) Chemical concentration too rich.										•		
D) Chemical concentration too lean.	•										•	

Possible Cause / Solution

- | | |
|---|---|
| <ol style="list-style-type: none"> 1. Temperature too high – Decrease water temperature. 2. Hose too long or wrong size or kinked; must be 3/8" I.D. – Maximum recommended length is 75'. Straighten the hose. 3. Nozzle size too small – Nozzle must match injector (see chart, pg. 2). 4. Solution check valve clogged or failed – Clean or replace solution check valve. 5. Water strainer element clogged – Clean the water strainer element. [Completely unscrew strainer cap from strainer for easy cleaning or replacement of strainer element; see diagram, pg. 3.] 6. Chemical tube not immersed in chemical or chemical depleted – Immerse tube or replenish. 7. Chemical strainer or metering tip blocked – Clean or replace chemical strainer and/or tip. | <ol style="list-style-type: none"> 8. Chemical tube stretched out where tube slides over check valve or pin hole/cut in chemical tube – Cut approximately 1/2" off end of tube or replace tube. 9. Vacuum leak in chemical pick-up assembly – Tighten the connection(s). 10. Chemical to water ratio too high – Install smaller tip. 11. Chemical to water ratio too low – Install larger tip. 12. Water scale or chemical build-up may have formed in the injector body causing poor pick-up – To descale, carefully remove body and soak <i>entire</i> injector body in descaling acid. |
|---|---|

Lafferty Equipment Manufacturing, Inc.

5614 Oak Grove Road
North Little Rock, AR 72118
Telephone: (501) 851-2820 — FAX: (501) 851-3719

Made in the U.S.A.

Distributed by: