

LAFFERTY EQUIPMENT MFG., INC. INSTALLATION / OPERATION INSTRUCTIONS

37.4 GALLON INTERNAL CHEMICAL TANK FOAMER

Requirements

40 – 80 PSI Air — Up to 10 SCFM
3/4" I. D. Discharge Hose

Water Temperature

Ambient to 140° F



Model # 925937, 37.4 Gallon Internal Chemical Tank Foamer
(with 40' hose, ball valve, wand, and nozzle)

Ask about our *External Chemical Tank Foamers* for use
with highly corrosive chemicals.

INSTALLATION AND OPERATION INSTRUCTIONS

37.4 GALLON

INTERNAL CHEMICAL TANK FOAMER

CAUTION: ALWAYS OBSERVE GOOD SAFETY HABITS. WEAR PROTECTIVE CLOTHING, GLOVES, AND EYE WEAR. DIRECT DISCHARGE AWAY FROM YOURSELF AND OTHERS.

DO NOT USE ANY CHEMICALS THAT ARE NOT COMPATIBLE WITH 316 STAINLESS STEEL — including hydrochloric (muriatic) acid, hydrofluoric acid, aluminum brighteners, or paint strippers. MANUFACTURER ASSUMES NO LIABILITY FOR USE OR MISUSE OF THIS UNIT.

TO OPERATE (See Parts Diagram, Facing Page)

1. Pull wire handle up to unlock the tank lid. Then remove the lid from the tank, making sure the “O” ring remains attached. Fill tank with chemical solution, then replace the tank lid, *making sure the “O” ring seats properly*. Lock wire handle in place.
2. Make sure the air ball valve is closed. Connect a compressed air line (3/8" minimum) to the foamer.
3. Next, make sure the discharge ball valve on the foam hose assembly is closed.
4. Open the air ball valve. **Allow time for pressure to build up, approximately 20 – 30 seconds.**
5. While firmly holding the foam wand, ***point the discharge away from yourself and others.*** Then, open the discharge ball valve. Observe foam quality.
6. The tank pressure air regulator (top) comes preset at 60 PSI and the foam consistency air regulator (bottom) comes preset at approximately 30 PSI. Foam consistency can be changed by adjusting the air pressure with the bottom air regulator.

AIR REGULATION PROCEDURES

Air pressure is very important for proper operation; air pressure must be LOWER than tank water pressure. Pull out adjustment knob on **bottom air regulator**, and turn it *slowly clockwise* to increase air pressure until desired foam consistency is achieved. Make only slight adjustments, then wait to see the results. If the flow of foam surges and/or hose “bucks,” you must decrease the air pressure by *slightly* turning the regulator **counterclockwise** until the foam stabilizes. “Fine tune” your adjustments by making *slight* turns **clockwise and/or counterclockwise** until foam is desired consistency. Once adjustments are made, push lock **air regulator**.

7. To prevent streaking, apply foam in a thin layer from the bottom and work up.

8. When foaming is completed, close the ball valve on the foam hose assembly; store hose on rack.
9. **Rinse before the foam dries.**

TO SHUT DOWN OR REFILL TANK

1. Turn off the air supply by closing the air ball valve.
2. Pull the ring on the pop-off relief valve up to **relieve tank pressure completely**. Then, open the discharge ball valve to relieve pressure on the hose.
3. Store unit or refill tank with chemical solution.
4. To refill the tank, pull wire handle up to unlock tank lid *after completely relieving tank pressure*. Then remove the lid from the tank making sure “O” ring remains attached. Fill tank with chemical solution, then replace the tank lid, making sure the “O” ring seats properly. Lock wire handle in place.

NOTE: Perform preventive maintenance when the unit will be out of service for extended periods. **When using corrosive chemicals, empty tank of any remaining chemical solution, then partially fill tank with clear water, recharge the tank with air, open discharge ball valve, and flush the entire system before storing.**

CAUTION!

**SHUT DOWN AFTER EACH USE!
NEVER LEAVE FOAMER UNATTENDED
WITHOUT CLOSING THE AIR BALL
VALVE AND RELIEVING PRESSURE IN
THE HOSE.**

37.4 GAL INTERNAL CHEMICAL TANK FOAMER - MODEL # 925937

Drawing not to scale

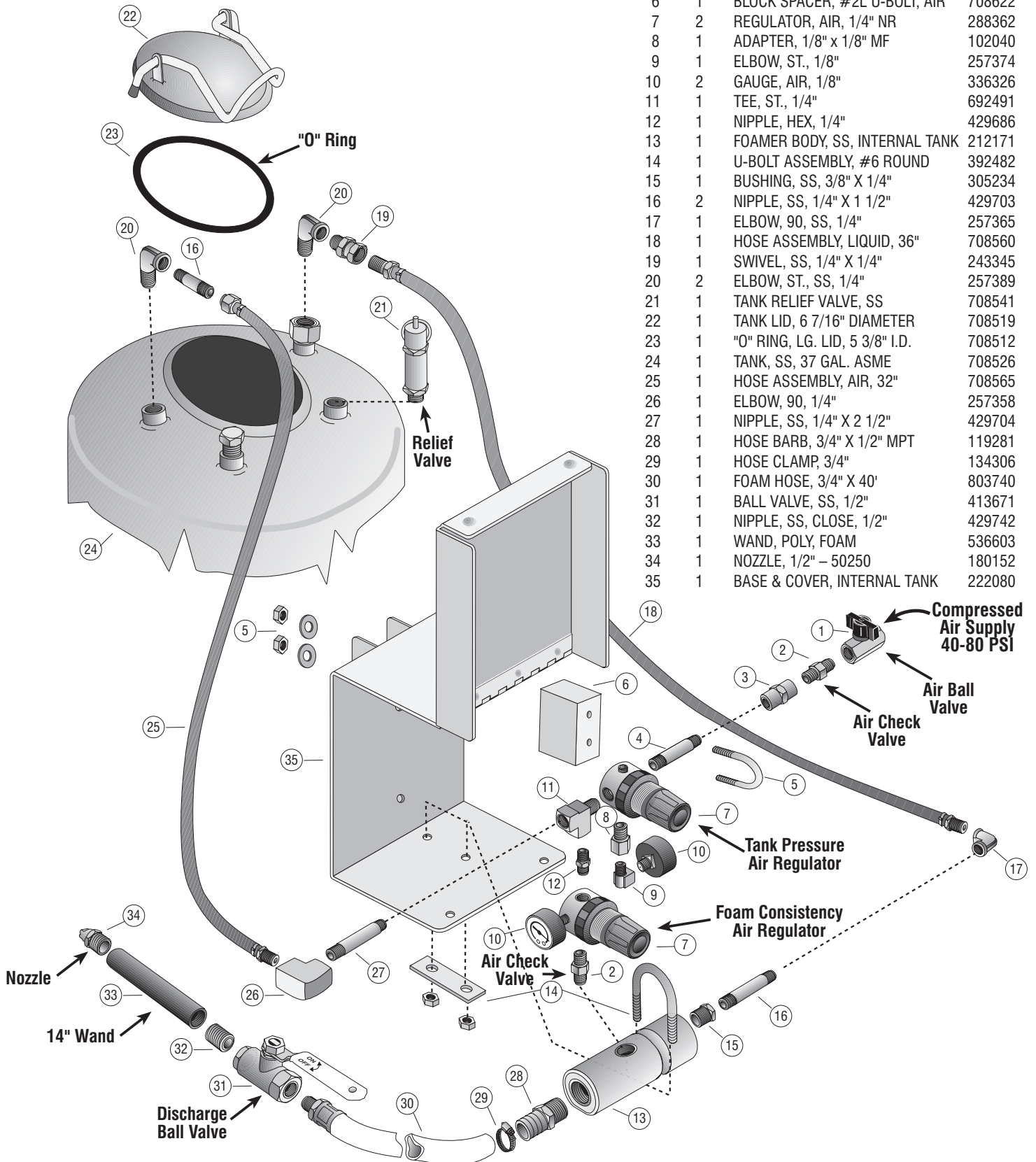

CALL #	QTY.	DESCRIPTION	PART #
1	1	BALL VALVE, 1/4" FFB	413602
2	2	CHECK VALVE, AIR, SS, 1/4"	491306
3	1	COUPLING, HEX, 1/4"	506668
4	1	NIPPLE, SS, 1/4" X 2"	429702
5	1	U-BOLT ASSEMBLY, #2L	392478
6	1	BLOCK SPACER, #2L U-BOLT, AIR	708622
7	2	REGULATOR, AIR, 1/4" NR	288362
8	1	ADAPTER, 1/8" x 1/8" MF	102040
9	1	ELBOW, ST., 1/8"	257374
10	2	GAUGE, AIR, 1/8"	336326
11	1	TEE, ST., 1/4"	692491
12	1	NIPPLE, HEX, 1/4"	429686
13	1	FOAMER BODY, SS, INTERNAL TANK	212171
14	1	U-BOLT ASSEMBLY, #6 ROUND	392482
15	1	BUSHING, SS, 3/8" X 1/4"	305234
16	2	NIPPLE, SS, 1/4" X 1 1/2"	429703
17	1	ELBOW, 90, SS, 1/4"	257365
18	1	HOSE ASSEMBLY, LIQUID, 36"	708560
19	1	SWIVEL, SS, 1/4" X 1/4"	243345
20	2	ELBOW, ST., SS, 1/4"	257389
21	1	TANK RELIEF VALVE, SS	708541
22	1	TANK LID, 6 7/16" DIAMETER	708519
23	1	"O" RING, LG. LID, 5 3/8" I.D.	708512
24	1	TANK, SS, 37 GAL. ASME	708526
25	1	HOSE ASSEMBLY, AIR, 32"	708565
26	1	ELBOW, 90, 1/4"	257358
27	1	NIPPLE, SS, 1/4" X 2 1/2"	429704
28	1	HOSE BARB, 3/4" X 1/2" MPT	119281
29	1	HOSE CLAMP, 3/4"	134306
30	1	FOAM HOSE, 3/4" X 40"	803740
31	1	BALL VALVE, SS, 1/2"	413671
32	1	NIPPLE, SS, CLOSE, 1/2"	429742
33	1	WAND, POLY, FOAM	536603
34	1	NOZZLE, 1/2" - 50250	180152
35	1	BASE & COVER, INTERNAL TANK	222080

TROUBLESHOOTING GUIDE

for

37.4 GALLON INTERNAL CHEMICAL TANK FOAMER

PROBLEMS WITH FOAMER	POSSIBLE CAUSE / SOLUTION											
	1	2	3	4	5	6	7	8	9	10	11	12
A) Foam surges and/or hose "bucks."	•	•	•	•		•	•	•	•	•	•	
B) Foam output too wet.		•	•	•	•	•	•	•		•	•	
C) Foam output too dry.	•			•								
D) Foam does not clean properly.										•	•	•

POSSIBLE CAUSE / SOLUTION

- | | |
|--|---|
| <ol style="list-style-type: none"> 1. Air pressure too high for available tank solution pressure – Adjust the bottom air regulator slowly counterclockwise. 2. Use of an oiler on the airline will cause poor foam quality – Use only clean, dry air. 3. Inadequate air supply – Open air inlet valve fully. Adjust bottom air regulator slowly clockwise. 4. Air regulator(s) clogged or failed – Clean or replace air regulator(s). 5. Air check valve(s) clogged or failed – Clean or replace the air check valve(s). 6. Foam hose too long or wrong size or kinked; must be 3/4" I.D. – Supplied with 40' hose. Maximum recommended length is 75'. | <ol style="list-style-type: none"> 7. Nozzle size too small – Must be a 50250 nozzle. 8. Discharge ball valve not completely open – Completely open the discharge ball valve. 9. Tank is empty (no solution) – Follow refill tank procedure (pg. 3). 10. Improper chemical – Ensure product is recommended for foaming and/or the application. 11. Weak chemical solution – Increase chemical concentration. 12. Soil has hardened on surface – Reapplication may be necessary. Always rinse foam before it dries. |
|--|---|

Lafferty Equipment Manufacturing, Inc.

5614 Oak Grove Road
 North Little Rock, AR 72118
 Telephone: (501) 851-2820 — FAX: (501) 851-3719

Made in the U.S.A.

Distributed by: