

LAFFERTY EQUIPMENT MFG., INC. INSTALLATION / OPERATION INSTRUCTIONS

HV PUMP FED FOAMER

Requirements

- 40 – 150 PSI Solution — Up to 5 GPM per unit
- 25 – 100 PSI Air — Up to 14 SCFM
- 1" I. D. Discharge Hose

Model # 919350, HVPFPB Foamer
(Poly Body, Nickel-Plated Brass Fittings)

Model # 919355, HVPFPS Foamer
(Poly Body, Stainless Steel Fittings)

TO INSTALL (See Parts Diagram, Over)

1. **Standard foamer is provided without a solution strainer. Flush lines before use and/or install a solution strainer.** Mount the foamer(s) to a suitable surface.
2. Connect your premixed solution* and air lines to the HV Pump Fed Foamer. [*Dosatron proportional liquid dispensers or double diaphragm air pumps work well with this unit.]
3. Connect the foam hose to the hose barb and secure with the clamp. **[Foam hose must be 1" I.D.]**
4. Connect the foam wand assembly to the hose. **[Use only the 3/4" nozzle supplied with foamer. If your solution pressure exceeds 100 PSI remove the discharge ball valve.]**

Air Adjustment Guidelines

For desired foam consistency, you may need to adjust the air pressure with the air regulator and the volume with the needle valve. To make adjustments, turn the regulator knob 1/4 of a revolution at a time. Then, turn the needle valve slightly. Wait to see the results before continuing.

TO OPERATE

1. Make sure the needle valve is turned completely **clockwise**. Then, turn the needle valve 2 - 3 *complete* turns **counterclockwise**. Next, pull out the adjustment knob on the air regulator.
2. While firmly holding the foam wand, **point the discharge away from yourself and others**. Then, open the discharge ball valve. Open the solution ball valve and the air ball valve and observe foam quality. If foam is too wet:
 - A. Turn air regulator knob **clockwise** to increase pressure until foam is desired consistency. If flow of foam surges and/or becomes too dry, turn the needle valve **clockwise** to decrease volume until foam is desired consistency. It may be necessary to "fine tune" your adjustments by turning the regulator and needle valve **clockwise** and/or **counterclockwise** until foam is desired consistency.
 - B. If foam is still too wet or surging after trying all combinations of adjustments, try increasing the chemical concentration and/or see Troubleshooting Guide (bottom). When foam is desired consistency, push lock the air regulator.
3. Foam from the bottom and work up to prevent streaking.
4. When foaming is completed, close the optional discharge ball valve. Return to foamer and close the solution ball valve. Then slowly re-open the discharge valve. Expect a strong blast of foamy solution. After hose is cleared out, close the air valve and store the hose.
5. Rinse the work surface before the foam dries.

CAUTION: Shut down after each use! Never leave foamer unattended without closing the incoming solution and air valves and relieving pressure in the hose.

PROBLEMS	POSSIBLE CAUSE / SOLUTION												
	1	2	3	4	5	6	7	8	9	10	11	12	13
A) Poor foam quality and/or hose "bucks."	•	•	•	•		•	•	•	•	•	•		•
B) Foam output too wet.		•	•	•	•	•	•	•	•	•	•		•
C) Foam output too dry.	•			•									
D) Foam does not clean properly.										•	•	•	
E) Chemical solution backing up into air line.					•								

POSSIBLE CAUSE / SOLUTION

- | | |
|--|---|
| <ol style="list-style-type: none"> 1. Air pressure/volume too high for available solution pressure – Slightly adjust needle valve clockwise and/or air regulator slowly counterclockwise. 2. Use of an oiler on the airline will cause poor foam quality – Use only clean, dry air. 3. Inadequate air supply – Open air inlet valve fully/adjust needle valve counterclockwise and/or regulator clockwise. 4. Needle valve and/or air regulator clogged or failed – Clean or replace needle valve or air regulator. 5. Air check valve clogged or failed – Clean or replace. 6. Foam hose too long or wrong size or kinked; must be 1" I.D. – Maximum recommended length is 75'. Straighten the hose. 7. Nozzle size too small – Must be part #180154 nozzle. | <ol style="list-style-type: none"> 8. Solution and/or optional discharge ball valves not completely open – Completely open the solution and discharge ball valves. 9. Foamer inlet clogged – Clean the foamer inlet. 10. Improper chemical – Ensure product is recommended for foaming and/or the application. 11. Weak chemical solution or solution pressure too low (minimum 35 PSI) – Increase chemical concentration and/or pressure. 12. Soil has hardened on surface – Reapplication may be necessary. Always rinse foam before it dries. 13. Chemical build-up may have formed in the foamer, restricting solution flow – Carefully remove body and soak <i>entire</i> foamer body in hot water and/or descaling acid. |
|--|---|

HV PUMP FED FOAMER

QTY.	CALL #	DESCRIPTION	PART #
1	1	BALL VALVE, SS, 3/8"	413659HVFPFS
(Not shown)		BALL VALVE, NPB, 3/8" FF(A)	413623HVFPFB
1	2	NIPPLE, SS, 3/8" x 1 1/2"	429711
1	3	FOAMER BODY, PUMP FED, HV, POLY	212150
1	4	HOSE BARB, 1" x 3/4" MPT	119293
1	5	ELBOW, ST. 3/8"	257380
1	6	BUSHING, 3/8" x 1/4"	305216
1	7	CHECK VALVE, AIR, SS 1/4"	491306
1	8	ELBOW, 90°, 1/4"	257358
1	9	NEEDLE VALVE, 1/4"	660797
1	10	NIPPLE, HEX, 1/4"	429686
1	11	BALL VALVE, 1/4" FFB	413602
1	12	NIPPLE, SS, 1/4" x 2"	429702
1	13	REGULATOR, AIR, 1/4"	288360
1	14	HOSE, AIR, 1/4" x 24"	195182
2	15	SCREW, HHSS #10 x 1"	396464
1	16	BASE & COVER, HV/HVHC (SET)	222555
1	17	NOZZLE, 3/4" - HV	180154
1	18	HOSE CLAMP, 1"	134311
1	19	HOSE, 1" x 50', 3/4" MPT	801251
*	20	BALL VALVE, NPB, 3/4" FM(A)	413648
(Not shown)		BALL VALVE, SS(A), 3/4"	413673
(Not shown)		NIPPLE, SS, CLOSE, 3/4"	429745
1	21	WAND, FOAM, HV, 14"	536605

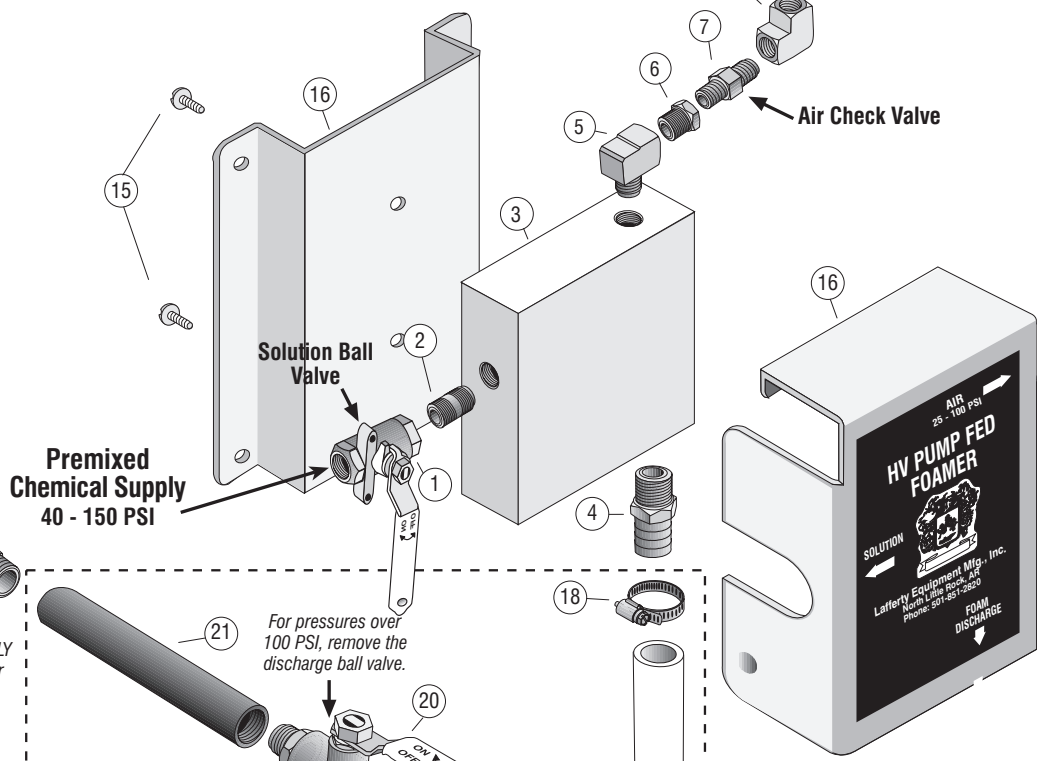
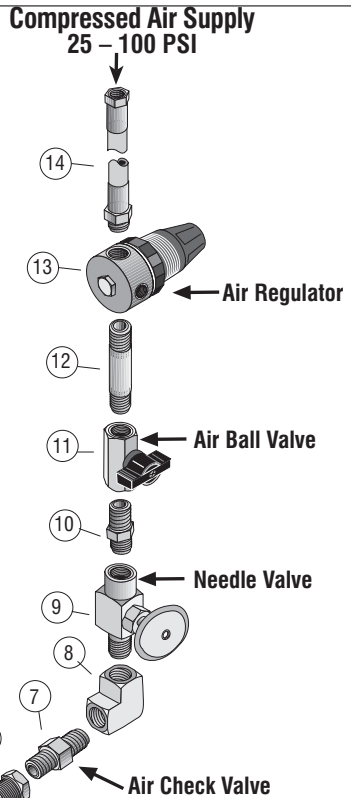

Foam Nozzle (17)
For proper operation, use **ONLY** the nozzle supplied with your HV Pump Fed Foamer.

OPTIONAL (Not Shown)
Stainless Steel Hose Rack - Part # 224150

OPTIONAL Hose Assembly (Parts # 18, 19, 20 & 21)

#802605, 1" x 50' hose assy. w/ open flow wand - #s 18, 19, & 21
 #802610, 1" x 50' hose assy. w/ nickel-plated ball valve and foam wand - #s 18, 19, 20, & 21
 #802615, 1" x 50' hose assy. w/ stainless steel ball valve and foam wand - #s 18, 19, 20, & 21

Lafferty Equipment Manufacturing, Inc.
 5614 Oak Grove Road
 North Little Rock, AR 72118
 Telephone: (501) 851-2820 — FAX: (501) 851-3719
Made in the USA

Distributed by: